



30th Kota Kinabalu Music and Dance Festival 2025

Rules & Regulations

(applicable to all categories)

APPENDIX A

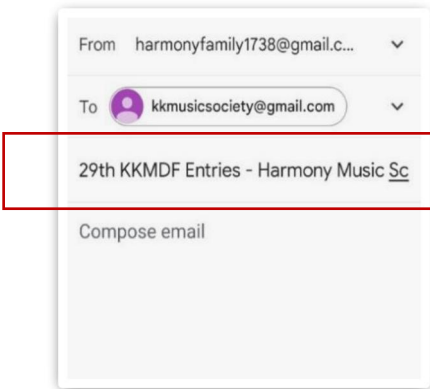
Table No.	SUBJECT	DETAILS
A1	SUBMISSION OF ENTRIES	<p>OPENS on Wednesday, 12th March 2025 from 9:00am to 12:00pm (noon)</p> <p>Duration: 3 hours (Any entry before and after the above time will not be accepted and considered VOID without refund.)</p> <p>All responsibility lies with the person/teacher who submits the forms.</p>
A2	DOWNLOAD & UPLOAD	<ol style="list-style-type: none"> Download and understand the Rules & Regulations and Codes & Fees from our official website: kkmusicfestival.my <small>*it may be under maintenance if the website cannot be found. Please try again later.</small> Download the Entry Forms (both in one file, Solo & Group in Excel format) from our official website when notified in our social media (Facebook & Instagram). During submission, please UPLOAD all the attachments and email us at kkmusicociety@gmail.com with the Subject entitled: <u>30th KK MDF Entries – [Teacher or School Name]</u> <p>For example, on your email interface:</p> 

A3 ENTRY FORMS MANAGEMENT

Please fill in all the details manually and clearly with correct spelling, code and fees.

a. Solo Entry Form, for example:

No.	Participant's Name (to print on certificate)	Gender	Date of Birth	Music Title	Composer	Duration	Instrument	Level	Code
1	Jane Lo	F	Xxx	Fur Elise (Easy)*	Beethoven	1.5	Piano	1	CG1
2	Kate Wong	F	Xxx	Mozzie	Milne	1.0	Piano	1	MG2

*please state (Easy) if your piece is a simplified version, or (Variation) if your piece is a variation or has been improvised.

b. Group Entry Form, for example:

No.	Group Name & Participant's Name (to appear on certificate)	Gender	Date of Birth	Music Title	Composer	Duration	Group	Level	Code
1	Jane Lo	F	Xxx	Easy Lemon	Xxx	1.5	Piano Duet	Elementary	EEM
	Kate Wong	F	Xxx						
2	John Lee	M	Xxx	Memories	Xxx	1	Violin Duet	Elementary	EEM
	Jess Lee	F	Xxx						

*One music piece is considered as ONE ENTRY (except for Choir, refer to App. B3)

- c. When stating the code, please type **CG1** (without space, not CG_1).
- d. Please keep the Entry Form in its original EXCEL format; **not** in PDF or a screenshot.
- e. Please RE-NAME your files as:

[Teacher/School/Person-in-Charge] 30th KKMDf ENTRY FORM

For example:

i. in your smartphone

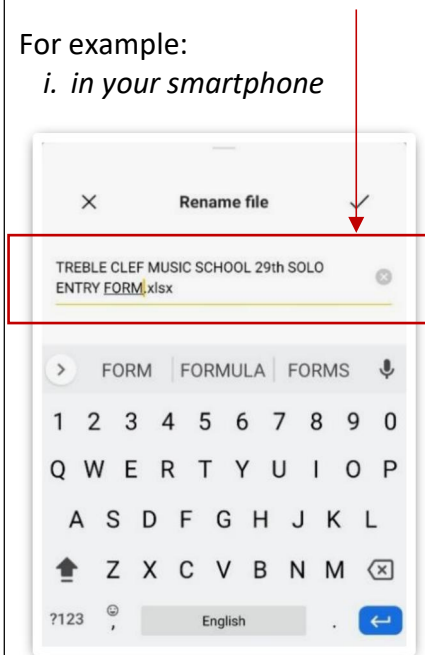

ii. in your computer/laptop

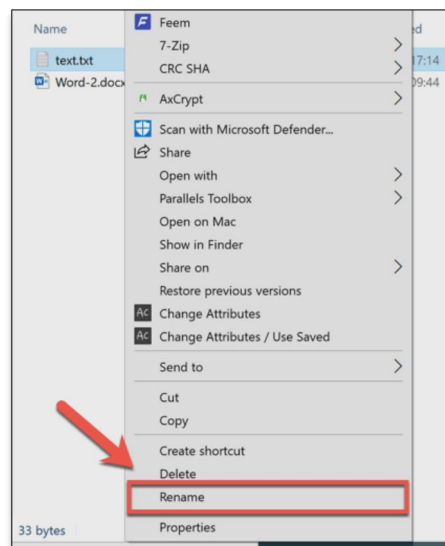

Example: TREBLE MUSIC SCHOOL 30th KKMDf ENTRY FORM

***One email address owner is eligible to submit one form only to the maximum of 30 entries only, to make a one-off payment, which is paid by one person-in-charge/school.**

<p>A4</p>	<p>MODE OF ENTRIES</p>	<p>Via E-MAIL only plus attachments of:</p> <ol style="list-style-type: none"> Proof of Payment such as Receipt, Screenshot of Transaction and in kind (PDF or photo); re-named accordingly. Entry Form in the original format, ie; EXCEL format; re-named accordingly. <i>Refer to A3.</i> Music Scores in PDF format, one file for each music piece, re-named accordingly. <i>Refer to A7.</i> Tracks or Music in MP3 format; one file for each music title, re-named accordingly. <i>Refer to A8.</i> <u>One</u> email address owner is eligible to submit <u>one</u> form only (inclusive both Solo & Group) to the maximum of 30 entries only. Equaling to <u>one-off</u> payment, which is paid by <u>one</u> person-in-charge/school.
<p>A5</p>	<p>MODE OF PAYMENT</p>	<ol style="list-style-type: none"> MALAYSIA <u>Only ONLINE TRANSFER is accepted.</u> Payment is to be made to: Name: PERTUBUHAN MUZIK KOTA KINABALU Bank: PUBLIC BANK Account number: 3216922202 OUTSIDE MALAYSIA Same bank details as above plus below: Swiftcode: PBBEMYKL <i>*Telegraphic Transfers must be in Malaysia Ringgit including any bank charges.</i> In the Reference spaces, please state: Ref1: 30KKMDF ENTRIES Ref2*: <i>[name of teacher/school/person-in-charge]</i> <i>*(only when your bank app has a Ref2 space)</i> Please repeat (c.) during payment of Purchase Form. Re-name your receipt/document: such as PDF or jpeg. photo as <i>[teacher/school/person-in-charge]</i> <div data-bbox="1139 1317 1458 1733" data-label="Image"> </div> <p><i>Figure 1: example of an 'online transfer' interface in smartphone</i></p> <div data-bbox="544 1827 884 2007" data-label="Image"> </div> <p><i>Figure 2: renamed files will appear like this when you attach in your email draft</i></p>

<p>A6</p>	<p>INCOMPLETE ENTRIES</p>	<p>Incomplete Entries will render whole submission void and there will be no refund.</p> <p>DEFINITION of Incomplete Entries:</p> <ol style="list-style-type: none"> Incorrect Category – i.e: entered the code of <i>Baroque</i> music as <i>Modern</i>. Missing Receipt of Payment. Missing Details – email address, name, date of birth, category, level, code, fee, music title, composer. PDF Error – missing page, missing notes, upside-down, blurry page, too small, too big, combining all files into 1 file, same piece but saved in separate PDF pages, having extra irrelevant page, SVG and PNG files. MP3 Error - incomplete music, not minus-one version, Midi and MXL and MPEG files. Late Payment – any payment after Submission hours in A1. Payment can be done any time before Submission. Wrong format of Entry Form (Excel forms), PDF or MP3. (Payment receipt can be in PDF format or a screenshot picture). Multiple Entry Forms under one email address – few persons/school sharing. All will be void.
<p>A7</p>	<p>PDF FILE MANAGEMENT</p>	<p>a. Examples below show good and acceptable PDF of music scores:</p> <p>i. Solo Scores</p> <div data-bbox="533 994 1114 1323"> </div> <p>This is clear, easy to read by the adjudicator.</p> <p>Figure 3: example on PDF reader interface on computer</p> <p>ii. Duet/Trio Scores</p> <div data-bbox="480 1413 1461 1995"> </div> <p>or</p> <p>Primo & Secondo in 1 page-view*</p> <p>*For adjudicator's easy reference during competition</p>

b. Please **RE-NAME** each PDF file, for example:

[PARTICIPANT NAME Music Title CODE]

i. On your smartphone, in CamScanner app:

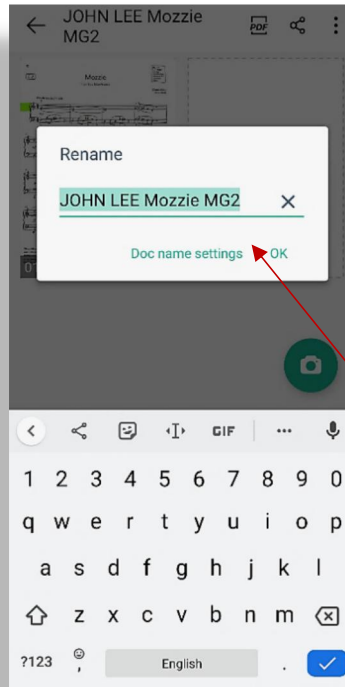

Click on the title of your piece, and this will appear for you to re-name, for example:

PARTICIPANT NAME: **JOHN LEE**

Music Title: **Mozzie**

CODE: **MG2**

Thus, type:

JOHN LEE Mozzie MG2

(for name & title, capital or small letters accepted)

Figure 4: example of the CamScanner app interface in your smartphone

ii. On your computer/laptop: click TITLE and press the Right Click, choose **Rename** and type in the new title as above:

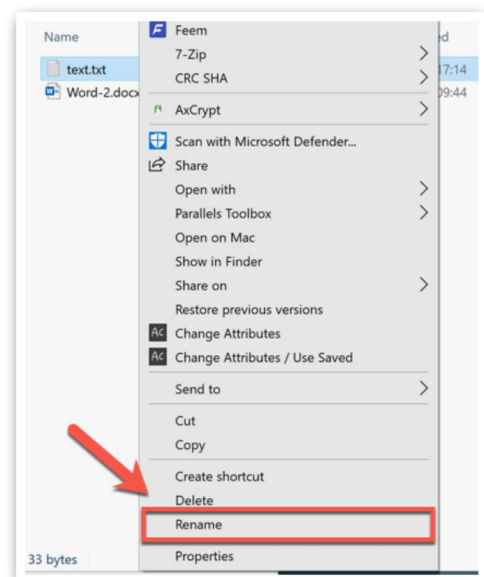

Figure 5: example of Windows interface on your laptop or desktop

A8	MUSIC & MP3 MANAGEMENT	<p>a. Categories that may need backing tracks should be saved in MP3 format only. (NOT .midi, .wav, .mpeg or .mxi)</p> <p>b. Please ensure that the music is within the permitted duration as stated in the Codes & Fees, according to the selected level. You may need to edit your music to comply the requirement accordingly.</p> <p>c. Re-name your MP3 file, for example: [PARTICIPANT NAME Music Title CODE]: <u>JANE LO Titanium SDJC</u></p> <p>d. All backing tracks must be submitted in MP3 format during Submission of Entries, Appendix A1.</p>
A9	PARTICIPANT MANAGEMENT	<p>a. A participant is <u>ONLY ALLOWED maximum 2 entries</u> this year. Combination is permissible but please ensure that they are not in the same grade of same instrument. <i>Example: a student named Jane Lo participates in Grade 1 Classical Piano (CG1) + Elementary Piano Duet (EEP) is allowed. Another student participates in Grade 2 Modern Piano (MG2) + Solo Dance is allowed.</i></p> <p>b. A participant cannot enter twice in the same category and level, unless it is of different music period, instrument or dance. <i>Example: RG1 + RG1, even though different pieces, is not allowed.</i></p> <p>c. A participant re-entering the same category and level, which s/he has won a GOLD in the past, will be disqualified with no refund.</p> <p>d. Any amendment of participant's name spelling will be charged MYR100 after submission.</p>
A10	PERFORMING BY MEMORY	<p>a. All Solo, Duet and Trio instrumental performances must be played from memory.</p> <p>b. Optional for Quartets and Ensembles/Band.</p>
A11	ACCOMPANIST MANAGEMENT	<p>a. Please fill in the <i>Accompanist Details</i> in the Entry Form with name, IC number and type of instrument they play.</p> <p>b. The Accompanist Fee is MYR20 per accompanist*, to be paid together during Submission of Entries.</p> <p>c. An accompanist can accompany up to maximum <u>5 entries</u>, for the same participant, and under the same music school.</p> <p>d. An accompanist is not allowed to be shared by different schools.</p> <p>e. The accompanist will be given a wrist-tag, only for the day that he/she is performing. Please collect at the counter on Festival Day.</p> <p>f. A change to accompanist is not allowed after Submission; however, it is only permissible with medical reason, with a fee of MYR200 per change.</p> <p>g. In the case of Self-Accompany, please state Self-Accompany and state the instrument you play.</p>
A12	PENALTIES	<p>a. Any change to Accompanist's name after submission will be charged MYR200. <i>Refer to A11.</i></p> <p>b. Any correction to Participant's name on the Certificate of Participation will be charged RM100 for each certificate re-print.</p>

A13	SCHEDULE OF COMPETITION	<p>1. The Schedule of the competition will be released and emailed to the respective teacher/school/person-in-charge on:</p> <p style="text-align: center;">Wednesday, 11th June 2025</p> <p>2. This email will be attached with the Purchase Form, where you can purchase early-bird Audience Tickets and Buffet Lunch Vouchers in advance. <i>Refer to A14 and A15.</i></p> <p>3. Please read the updates and follow the instructions given in this email.</p>									
A14	PURCHASE FORM	<p>1. Submission for the Purchase Form will be on</p> <p style="text-align: center;">Wednesday, 9th July 2025, from 9:00am to 12:00pm (noon).</p> <p>2. In your online transfer payment details, please state: Ref1: 30KKMDF PURCHASE FORM Ref2*: <i>[name of teacher/school/person-in-charge]</i> <small>*(only when your bank app has a Ref2 space)</small></p>									
A15	EARLY-BIRD PURCHASES	<table border="1" data-bbox="491 808 1465 1088"> <thead> <tr> <th>Items</th> <th>ADULT</th> <th>CHILD</th> </tr> </thead> <tbody> <tr> <td>Audience Ticket Day Pass</td> <td>MYR20 per day (13 years old & above)</td> <td>MYR15 per day (3 – 12 years old)</td> </tr> <tr> <td>Buffet Lunch Voucher*</td> <td>MYR60 per day (12 years old & above)</td> <td>MYR40 per day (5 – 11 years old)</td> </tr> </tbody> </table> <p><small>*Buffet Lunch Voucher is only available in Early-bird Purchases (not available on the day and walk-in).</small></p>	Items	ADULT	CHILD	Audience Ticket Day Pass	MYR20 per day (13 years old & above)	MYR15 per day (3 – 12 years old)	Buffet Lunch Voucher*	MYR60 per day (12 years old & above)	MYR40 per day (5 – 11 years old)
Items	ADULT	CHILD									
Audience Ticket Day Pass	MYR20 per day (13 years old & above)	MYR15 per day (3 – 12 years old)									
Buffet Lunch Voucher*	MYR60 per day (12 years old & above)	MYR40 per day (5 – 11 years old)									
A16	AUDIENCE TICKET DAY PASS - RATES & PRIVILEGES	<p>a. Audience Tickets are available for purchase on the day:</p> <table border="1" data-bbox="684 1223 1493 1272"> <tr> <td style="text-align: center;">Flat Day-Pass Rate</td> <td style="text-align: center;">MYR30 per pax</td> </tr> </table> <p>i. KKMS Member – MYR10 per day* ii. Senior Citizen 65 and above – Free* iii. Orang Kelainan Upaya (OKU) – Free*</p> <p>b. For above marked * - please bring ID, IC or OKU card to purchase them on each of the Festival Day.</p>	Flat Day-Pass Rate	MYR30 per pax							
Flat Day-Pass Rate	MYR30 per pax										
A17	YOUR CHECKLIST	<p><u>Wednesday, 12th March 2025 – Submission of Entries</u></p> <ul style="list-style-type: none"> <input type="checkbox"/> Payment in Total Amount – <i>Receipt in PDF/photo</i> <ul style="list-style-type: none"> • Total Entry Fee • Accompanist Fee, if applicable • Rename every document and file (Form, Receipts, PDF and MP3). <input type="checkbox"/> The ENTRY FORM (both Solo & Group inclusive) <input type="checkbox"/> Relevant Files: PDF <input type="checkbox"/> and/or MP3 <input type="checkbox"/> <p><u>Wednesday, 11th June 2025 – Release of Competition Schedule</u></p> <p><u>Wednesday, 9th July 2025 – Purchase Form Submission</u></p> <ul style="list-style-type: none"> <input type="checkbox"/> Payment in Total Amount – <i>Receipt in PDF/screenshot</i> <ul style="list-style-type: none"> ✓ Prepaid Audience Tickets ✓ Buffet Lunch Voucher (only available here). <i>Refer to A15. - if applicable</i> ✓ Top Up Fees, etc - <i>if applicable</i> <input type="checkbox"/> Purchase Form, <i>follow instructions given in email</i> <p><small>*These checklists and tick-boxes are for your own use.</small></p>									

A18	TIMELINE REFERENCE	<table border="1"> <tr> <td data-bbox="496 170 1409 266"> <p>Wednesday, 15th January 2025, 9.00AM onwards - Purchase of Entries</p> </td> </tr> <tr> <td data-bbox="496 266 1409 353"> <p>Wednesday, 12th March 2025, 9.00AM to 12.00PM - Submission of Entries</p> </td> </tr> <tr> <td data-bbox="496 353 1409 450"> <p>Wednesday, 11th June 2025 - <i>Schedule of Competition</i> and <i>Purchase Forms</i> to be released.</p> </td> </tr> <tr> <td data-bbox="496 450 1409 546"> <p>Wednesday, 9th July 2025, 9.00AM to 12.00PM - Submission of <i>Purchase Forms</i></p> </td> </tr> <tr> <td data-bbox="496 546 1409 633"> <p>Wednesday, 6th August 2025 - Due date, Submission of <i>Artworks (BOK participants)</i></p> </td> </tr> </table>	<p>Wednesday, 15th January 2025, 9.00AM onwards - Purchase of Entries</p>	<p>Wednesday, 12th March 2025, 9.00AM to 12.00PM - Submission of Entries</p>	<p>Wednesday, 11th June 2025 - <i>Schedule of Competition</i> and <i>Purchase Forms</i> to be released.</p>	<p>Wednesday, 9th July 2025, 9.00AM to 12.00PM - Submission of <i>Purchase Forms</i></p>	<p>Wednesday, 6th August 2025 - Due date, Submission of <i>Artworks (BOK participants)</i></p>
<p>Wednesday, 15th January 2025, 9.00AM onwards - Purchase of Entries</p>							
<p>Wednesday, 12th March 2025, 9.00AM to 12.00PM - Submission of Entries</p>							
<p>Wednesday, 11th June 2025 - <i>Schedule of Competition</i> and <i>Purchase Forms</i> to be released.</p>							
<p>Wednesday, 9th July 2025, 9.00AM to 12.00PM - Submission of <i>Purchase Forms</i></p>							
<p>Wednesday, 6th August 2025 - Due date, Submission of <i>Artworks (BOK participants)</i></p>							
A19	DISQUALIFICATION MATTERS	<ol style="list-style-type: none"> 1. A participant will be disqualified without refund, if: <ol style="list-style-type: none"> a. the time duration is exceeded from the duration stipulated in the Rules & Regulations and Code & Fees. b. he/she (or the group) had already won Gold in the <u>same category and level</u> last year. This applies to all categories. 					

--- End of Appendix A ---

APPENDIX B

Table No.	SUBJECT	DETAILS																			
B1	INSTRUMENTAL AND VOICE - SOLO	<p>1. SOLO VOICE/VOCAL Categories:</p> <table border="1"> <thead> <tr> <th>Classical Singing</th> <th>Popular Singing</th> </tr> </thead> <tbody> <tr> <td> <p>a. A participant may choose to sing with or without an accompaniment.</p> <p>b. Should a participant choose accompaniment, only LIVE ACCOMPANIMENT is allowed.</p> <p>c. Please verify the style and period of your piece with your teacher. (You may select the category as in Baroque, Classical, Romantic or 20th Century.)</p> </td> <td> <p>a. A participant may choose to sing with a Minus-1 backing track or live accompaniment.</p> <p>b. Should a participant choose Live Accompaniment:</p> <p>i. With an accompanist – Accompanist Fee applies, <i>refer to A11</i>.</p> <p>ii. Self-accompaniment – Please state SELF-ACCOMPANY in the Entry Form under <i>Accompanist Details</i>. No fee applied.</p> <p>iii. If not using the piano, other instrument such as guitar or ukulele must be self-provision.</p> <p>c. Should a participant choose a Minus-1 backing track, it must be saved in MP3 format. <i>Refer to A8</i>.</p> </td> </tr> </tbody> </table> <p>d. In the case of Live Accompaniment, a piano is provided for the accompanist. Other instruments must be self-provision.</p> <p>e. Music scores for both categories must be in PDF format. <i>Refer to A7</i>.</p> <p>f. Please ensure that your music, including INTRO and OUTRO, is within the given time frame.</p> <p>2. For Solo Piano and Violin in DIPLOMA categories:</p> <p>a. TWO MOVEMENTS of the Sonata must be performed.</p> <p>b. The performance should not exceed 12 minutes.</p> <p>c. Please refer to the Codes and Fees for further details.</p> <p>3. Please do not repeat when there is a Da Capo. (Dal Segno is allowed)</p>	Classical Singing	Popular Singing	<p>a. A participant may choose to sing with or without an accompaniment.</p> <p>b. Should a participant choose accompaniment, only LIVE ACCOMPANIMENT is allowed.</p> <p>c. Please verify the style and period of your piece with your teacher. (You may select the category as in Baroque, Classical, Romantic or 20th Century.)</p>	<p>a. A participant may choose to sing with a Minus-1 backing track or live accompaniment.</p> <p>b. Should a participant choose Live Accompaniment:</p> <p>i. With an accompanist – Accompanist Fee applies, <i>refer to A11</i>.</p> <p>ii. Self-accompaniment – Please state SELF-ACCOMPANY in the Entry Form under <i>Accompanist Details</i>. No fee applied.</p> <p>iii. If not using the piano, other instrument such as guitar or ukulele must be self-provision.</p> <p>c. Should a participant choose a Minus-1 backing track, it must be saved in MP3 format. <i>Refer to A8</i>.</p>															
Classical Singing	Popular Singing																				
<p>a. A participant may choose to sing with or without an accompaniment.</p> <p>b. Should a participant choose accompaniment, only LIVE ACCOMPANIMENT is allowed.</p> <p>c. Please verify the style and period of your piece with your teacher. (You may select the category as in Baroque, Classical, Romantic or 20th Century.)</p>	<p>a. A participant may choose to sing with a Minus-1 backing track or live accompaniment.</p> <p>b. Should a participant choose Live Accompaniment:</p> <p>i. With an accompanist – Accompanist Fee applies, <i>refer to A11</i>.</p> <p>ii. Self-accompaniment – Please state SELF-ACCOMPANY in the Entry Form under <i>Accompanist Details</i>. No fee applied.</p> <p>iii. If not using the piano, other instrument such as guitar or ukulele must be self-provision.</p> <p>c. Should a participant choose a Minus-1 backing track, it must be saved in MP3 format. <i>Refer to A8</i>.</p>																				
B2	INSTRUMENTAL PIANO FOUR-HANDS, SIX HANDS & ENSEMBLES	<p>1. Please use the GROUP ENTRY FORM for these categories.</p> <p>2. There are two categories for piano ensemble:</p> <p>a. Four Hands on one piano (piano duet). Prepare one piece only.</p> <p>b. Six Hands on one piano (piano trio). Prepare one piece only.</p> <p>3. ENSEMBLES Categories:</p> <table border="1"> <thead> <tr> <th>Trios or Quartets</th> <th>Modern Ensembles (previously known as Combo Band)</th> </tr> </thead> <tbody> <tr> <td> <p>1. Mixed instruments with 3 – 4 members.</p> <p>2. Do not include Voice/Vocal.</p> </td> <td> <p>1. Mixed instruments with 5 – 6 members.</p> <p>2. Allowed to include Voice/Vocal.</p> <p>3. A standard digital piano, drum kit and amps for guitars will be provided.</p> </td> </tr> </tbody> </table> <p>3. Rearrangement of music and styles, combination of music and creativity are most welcome.</p> <p>4. Music score, lyrics, chords, any referable material must be in PDF format. <i>Refer to A7</i>.</p> <p>5. Other instruments like guitar, tambourine, etc. are to be prepared under participants' own responsibility.</p> <p>6. Please state your instruments in the Group Entry Form, <i>example:</i></p> <table border="1"> <thead> <tr> <th>...</th> <th>Level</th> <th>Code</th> <th>Fees RM</th> <th>Instrument</th> </tr> </thead> <tbody> <tr> <td>...</td> <td>Primary</td> <td>ETRQPC</td> <td>280</td> <td>Violin, Viola, Cello</td> </tr> <tr> <td>...</td> <td></td> <td></td> <td></td> <td></td> </tr> </tbody> </table>	Trios or Quartets	Modern Ensembles (previously known as Combo Band)	<p>1. Mixed instruments with 3 – 4 members.</p> <p>2. Do not include Voice/Vocal.</p>	<p>1. Mixed instruments with 5 – 6 members.</p> <p>2. Allowed to include Voice/Vocal.</p> <p>3. A standard digital piano, drum kit and amps for guitars will be provided.</p>	...	Level	Code	Fees RM	Instrument	...	Primary	ETRQPC	280	Violin, Viola, Cello	...				
Trios or Quartets	Modern Ensembles (previously known as Combo Band)																				
<p>1. Mixed instruments with 3 – 4 members.</p> <p>2. Do not include Voice/Vocal.</p>	<p>1. Mixed instruments with 5 – 6 members.</p> <p>2. Allowed to include Voice/Vocal.</p> <p>3. A standard digital piano, drum kit and amps for guitars will be provided.</p>																				
...	Level	Code	Fees RM	Instrument																	
...	Primary	ETRQPC	280	Violin, Viola, Cello																	
...																					
		<p>4. CHILDREN ENSEMBLES are for 7 years old and below only and:</p> <p>a. 6 - 10 members allowed per group;</p> <p>b. which they may include props, percussion and keyboards are to be prepared under participants' own responsibility;</p> <p>c. refer to the Code and Fees for further details such as category, codes, fees and time duration.</p>																			

<p>B3</p>	<p>CHOIR MANAGEMENT</p>	<p>a. One Entry Form per choir, where a minimum of 12 to a maximum of 30 persons per choir (including the Conductor and Accompanist.</p> <p>b. Categories of Age:</p> <table border="1" data-bbox="614 248 1406 360"> <tr> <td>Primary Level</td> <td>Children aged 12 and below</td> </tr> <tr> <td>Secondary Level</td> <td>Aged 13 and above</td> </tr> <tr> <td>Adult Level</td> <td>Non-students</td> </tr> </table> <p>c. Required to perform TWO CONTRASTING pieces not exceeding 7 minutes in total.</p> <p>d. Repertoire can be in any language.</p> <p>e. Every choir group is given 2 minutes to set up on stage during the competition.</p> <p>f. Music score is required in PDF format. <i>Refer to A7.</i></p> <p>g. Choir may perform <u>with or without</u> any accompaniment. A piano is provided for Live Accompaniment.</p> <p>h. Minus-1 music or backing track is NOT PERMITTED.</p>	Primary Level	Children aged 12 and below	Secondary Level	Aged 13 and above	Adult Level	Non-students
Primary Level	Children aged 12 and below							
Secondary Level	Aged 13 and above							
Adult Level	Non-students							
<p>B4</p>	<p>INSTRUMENTAL – TECHNICAL WORK on the PIANO</p>	<p>a. This category is open to all piano players only.</p> <p>b. This is the only category that respective winners are awarded in cash.</p> <p>c. Participants will be asked to perform at least one scale from each type of scales stated in the Table TW below.</p> <p>d. Participants are to select the level and prepare according to the requirements in the following table.</p>						

TABLE TW: TECHNICAL WORK on the PIANO

LEVELS	SCALES & ARPEGGIOS TO PREPARE
<p>Junior Level (Under 11 years old)</p> <p>PRIZES 1st: RM 100 2nd: RM 70 3rd: RM 50</p>	<p>Key: A, B, C, D, E, F, G (White Keys)</p> <p>Similar Motion Scales (Hands together and separately, Staccato and Legato) in Major, Natural, Harmonic and Melodic Minor – 2 octaves</p> <p>Contrary Motion (Hands Together and Legato only) in Major and Harmonic Minor – 2 octaves</p> <p>Chromatic Scales (Hands together and separately, Staccato and Legato) Starting on any white key – 2 octaves</p> <p>Arpeggios (Hands together and separately) in Root Position and Legato only in Major and Minor keys – 2 octaves</p>
<p>Intermediate Level (12 - 15 years old)</p> <p>PRIZES 1st: RM 150 2nd: RM 120 3rd: RM 100</p>	<p>Key: All 12 keys</p> <p>Similar Motion Scales (Hands together and separately, Staccato and Legato) in Major, Natural, Harmonic and Melodic Minor – 4 octaves</p> <p>Contrary Motion (Hands Together and Legato only) in Melodic minor, starting on white keys only – 2 octaves</p> <p>Chromatic Scales (Hands together only, Legato and Staccato) Starting on any key – 4 octaves</p> <p>Scales in 3rds (Separate hands and legato only) in Major and Harmonic Minor Starting on white keys only – 2 octaves</p> <p>Chromatic Minor Third Scales (Separate hands and Legato only) Starting on white keys only – 2 octaves</p> <p>Arpeggios (Hands together and separately) in Root Position and 1st Inversion In all Major and Minor keys – 4 octaves</p> <p>Dominant 7th of... (Hands together and separately) in Root Position only – 4 octaves Applicable to white keys only (C, G, D, A, E, B & F major keys)</p> <p>Diminished 7th of... (Hands together or separately) Applicable to all white keys – 4 octaves (C, G, D, A, E, B and F major keys)</p>

<p>Advance Level (16 years and above)</p> <p>PRIZES: 1st: RM 200 2nd: RM 150 3rd: RM 120</p>	<p>Key: All 12 keys</p> <p>Similar Motion Staccato Octave Scales (Hands together and separately) in Major, Natural, Harmonic and Melodic Minor – 2 octaves</p> <p>Scales in 3rds (Separate hands, Staccato and Legato) in Major and Harmonic Minor – 2 octaves</p> <p>Chromatic Minor Third Scales (Separate hands, Staccato and Legato only) Starting on all keys – 2 octaves</p> <p>Third (3rd) Apart Scales (Hands together, Staccato and Legato) in Major and Harmonic Minor – 4 octaves</p> <p>Sixth (6th) Apart Scales (Hands together, Staccato and Legato) in Major and Melodic Minor – 4 octaves</p> <p>Arpeggios (Hands together and separately) in all positions (Root Position, 1st inversion and 2nd inversion) in all Major and Minor keys – 4 octaves</p> <p>Dominant 7th of... (Hands together or separately) in all positions – 4 octaves Applicable to all keys</p> <p>Diminished 7th of... (Hands together or separately) Applicable to all keys - 4 octaves</p>
---	--

--- End of Table TW & Appendix B ---

APPENDIX C

Table No.	SUBJECT	DETAILS																																				
C1	DANCE – SOLO	<p>a. Please use Solo Entry Form for this category.</p> <p>b. Check the duration of your performance accordance to our rules.</p> <p>c. Rename your MP3: [name] [title] [CODE]. (e.g.: JOJO LEE The Swan SDPCY)</p> <p>d. Please save and submit your music or song in MP3 format. <i>Refer to A8.</i></p>																																				
C2	DANCE – DUET and GROUP	<p>a. Please use Group Entry Form for these categories.</p> <p>b. Check the duration of your performance accordance to our rules.</p> <p>c. Rename your MP3: [name] [title] [CODE]. (e.g.: RED QUEEN The Swan GSPMH)</p> <p>d. When filling in the Form, you may follow the example below:</p> <table border="1"> <thead> <tr> <th>No.</th> <th>Group and Participant's Name (as it to appear on certificate)</th> <th>Gender</th> <th>Date of Birth</th> <th>Music Title</th> <th>Code</th> </tr> </thead> <tbody> <tr> <td>1</td> <td>RED QUEEN</td> <td></td> <td></td> <td></td> <td></td> </tr> <tr> <td></td> <td>Jane Lo</td> <td>F</td> <td>30/09/2015</td> <td>The Swan</td> <td>GSPMH</td> </tr> <tr> <td></td> <td>John Lee</td> <td>M</td> <td>21/07/2016</td> <td></td> <td></td> </tr> <tr> <td></td> <td>Kate Wong</td> <td>F</td> <td>Xx/xx/xxxx</td> <td></td> <td></td> </tr> <tr> <td></td> <td></td> <td></td> <td></td> <td></td> <td>etc.</td> </tr> </tbody> </table> <p>e. Please save and submit your music or song in MP3 format. <i>Refer to A8.</i></p>	No.	Group and Participant's Name (as it to appear on certificate)	Gender	Date of Birth	Music Title	Code	1	RED QUEEN						Jane Lo	F	30/09/2015	The Swan	GSPMH		John Lee	M	21/07/2016				Kate Wong	F	Xx/xx/xxxx								etc.
No.	Group and Participant's Name (as it to appear on certificate)	Gender	Date of Birth	Music Title	Code																																	
1	RED QUEEN																																					
	Jane Lo	F	30/09/2015	The Swan	GSPMH																																	
	John Lee	M	21/07/2016																																			
	Kate Wong	F	Xx/xx/xxxx																																			
					etc.																																	
C3	AGE CATEGORY	<p>As of 2025 regardless of month.* <i>*Jojo Lee's birthday is on 25th December 2015, she is 10 years old in 2025.</i></p>																																				
C4	CATEGORIES NOT FOUND & DISCLAIMER	<ol style="list-style-type: none"> 1. Please take note that sports dances are not included, such as: Zumba, gymnastics, and pole dancing. 2. Categories are as given in the Codes and Fees schedule. Please select the appropriate category that applies to the participant. 3. If not found, it may be new to us, please email us to enquire about it, as soon as you read this document. 4. All the names used in the examples, in this document, are all created by fiction. Any similarity to names is entirely coincidental. 																																				

--- End of Appendix C ---

SPECIAL CATEGORY 2025

Thank you for your support, the Brush on Keys (BOK) is back by popular demand. Below is the update on this special category:

1. Brush on Keys (for solo piano and solo violin) is now available in 8 eight levels – Grade 1 to 8.
2. Brand new sets of repertoires are updated especially for this year. The set lists for BOK will be available in our official website:

<https://kkmusicfestival.my>

Rules and Regulations:

1. This category requires a participant to create a physical ARTWORK inspired by his or her choice of music piece chosen in the Set List.
2. The size of the artwork must be on an A3 (29.7cm X 42cm) either in a landscape or a portrait display.
3. Participants in this category must choose a piece from the **Brush on Keys Set Lists only** which will be available in our website.
4. The artwork must be the participant's original interpretation of the chosen music piece.
5. All forms of art media, such as colour pencils, watercolour, charcoal and collage, are acceptable **EXCEPT for digital media**.
6. Participant's details and selection of music piece should be included in the Solo Entry Form with *Codes & Fees* applied. Refer to Appendix A.
7. However, to allow time for participant to complete his/her creation, the artwork is to be submitted on or before Wednesday, 6th August 2025. *Refer to A18.*

BOK Category Timeline:



Purchase of Entries via Shopee Platform

Instructions:

1. Each entry costs 10 cents. For example, if you have 17 entries, please order 17 as your QUANTITY in your 'cart'. (Maximum 30 per order from one email address)
2. Click on CHECKOUT, and finish your order process.
3. Find [Contact Seller] or [Chat Now] and text us your name/school, email address and phone number.
for example: Treble Music School, treblemusicschool2020@hotmail.com, 012-345-6789

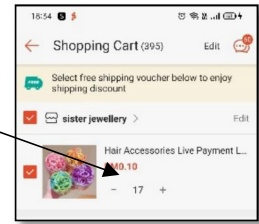

Terms and Conditions:

1. Each teacher or school or person-in-charge using one email address per Shopee account is only allowed one-time purchase of the **1 to the maximum 30 entries**.
2. Subsequent purchase will be void. Therefore, it is important you prepare the exact number of entries you need before you make the purchase.
3. Your purchase will only be successful after we have **confirmed** your order. **However, purchasing 31 or more entries will be instantly void and there will be no refund.**
4. For successful buyers, we will contact you via email/call for official confirmation.
5. Your Submission of Entries number must TALLY with the entries that you purchased in Shopee. Otherwise, the whole submission will be void and there will be no refund.
6. We reserved the right to cancel any purchase made through this link should there be any suspicion of ill intent and insincerity in the transaction.

REMINDER: One Shopee account, one email address, one contact number, one Entry Form, one person-in-charge for 1 to maximum 30 entries.

**Please note that you do not have to submit any form, PDF or MP3 at this moment.
We only need your NAME, E-MAIL ADDRESS and CONTACT NUMBER.**

Here is the link to **PURCHASE THE ENTRIES**.
Only open on Wednesday, 15th January 2025 at 9.00am onwards.